

“It Felt Like I Was Left in the Dark”: Exploring Information Needs and Design Opportunities for Family Caregivers of Older Adult Patients in Critical Care Settings

SHIHAN FU, Northeastern University, United States

BINGSHENG YAO, Northeastern University, United States

SMIT DESAI, Northeastern University, United States

YUQI HU, Northeastern University, United States

YULING SUN, University of Michigan, United States

SAMANTHA STONBRAKER, University of Colorado College of Nursing, United States

YANJUN GAO, University of Colorado Anschutz Medical Campus, United States

ELIZABETH M. GOLDBERG, University of Colorado Anschutz Medical Campus, United States

DAKUO WANG*, Northeastern University, United States

Older adult patients constitute a rapidly growing subgroup of Intensive Care Unit (ICU) patients. In these situations, their family caregivers are expected to represent the unconscious patients to access and interpret patients’ medical information. However, caregivers currently have to rely on overloaded clinicians for information updates and typically lack the health literacy to understand complex medical information. Our project aims to explore the information needs of caregivers of ICU older adult patients, from which we can propose design opportunities to guide future AI systems. The project begins with formative interviews with 11 caregivers to identify their challenges in accessing and interpreting medical information; From these findings, we then synthesize design requirements and propose an AI system prototype to cope with caregivers’ challenges. The system prototype has two key features: a timeline visualization to show the AI extracted and summarized older adult patients’ key medical events; and an LLM-based chatbot to provide context-aware informational support. We conclude our paper by reporting on the follow-up user evaluation of the system and discussing future AI-based systems for ICU caregivers of older adults.

CCS Concepts: • **Human-centered computing** → **Human computer interaction (HCI); HCI design and evaluation methods; Collaborative and social computing theory, concepts and paradigms**; • **Applied computing** → **Life and medical sciences**.

Additional Key Words and Phrases: Human-AI collaborations, family caregivers, critical care, large language models, information need

*Corresponding author

Authors’ Contact Information: Shihan Fu, Northeastern University, Boston, Massachusetts, United States, fu.shiha@northeastern.edu; Bingsheng Yao, Northeastern University, Boston, Massachusetts, United States, b.yao@northeastern.edu; Smit Desai, Northeastern University, Boston, Massachusetts, United States, sm.desai@northeastern.edu; Yuqi Hu, Northeastern University, Boston, Massachusetts, United States, hu.yuqi@northeastern.edu; Yuling Sun, University of Michigan, Ann Arbor, Michigan, United States, ; Samantha Stonbraker, University of Colorado College of Nursing, Aurora, Colorado, United States, Samantha.Stonbraker@CUAnschutz.edu; Yanjun Gao, University of Colorado Anschutz Medical Campus, Aurora, Colorado, United States, ; Elizabeth M. Goldberg, University of Colorado Anschutz Medical Campus, Aurora, Colorado, United States, elizabeth.goldberg@cuanschutz.edu; Dakuo Wang, Northeastern University, Boston, Massachusetts, United States, d.wang@northeastern.edu.

Permission to make digital or hard copies of all or part of this work for personal or classroom use is granted without fee provided that copies are not made or distributed for profit or commercial advantage and that copies bear this notice and the full citation on the first page. Copyrights for components of this work owned by others than the author(s) must be honored. Abstracting with credit is permitted. To copy otherwise, or republish, to post on servers or to redistribute to lists, requires prior specific permission and/or a fee. Request permissions from permissions@acm.org.

© 2018 Copyright held by the owner/author(s). Publication rights licensed to ACM.

Manuscript submitted to ACM

Manuscript submitted to ACM

1

ACM Reference Format:

Shihan Fu, Bingsheng Yao, Smit Desai, Yuqi Hu, Yuling Sun, Samantha Stonbraker, Yanjun Gao, Elizabeth M. Goldberg, and Dakuo Wang. 2018. "It Felt Like I Was Left in the Dark": Exploring Information Needs and Design Opportunities for Family Caregivers of Older Adult Patients in Critical Care Settings. In *Proceedings of Make sure to enter the correct conference title from your rights confirmation emai (Conference acronym 'XX)*. ACM, New York, NY, USA, 22 pages. <https://doi.org/XXXXXXXX.XXXXXXX>

1 Introduction

The Intensive Care Unit (ICU) is a specialized critical care ward in hospitals, which is dedicated to providing acute, life-saving treatment for patients with life-threatening conditions caused by severe illnesses [29, 68]. In the United States, older adults (aged 65 and above) account for more than half of ICU admissions, with the amount continuing to grow [6, 23, 34]. Such a vulnerable population of ICU patients has been the focus of care provision, however, caregivers of older adult patients are often overlooked in such critical care settings [27]. Caregivers of older adult patients are often their family members and are assigned powers of attorney to unconscious patients for making critical medical decisions [7, 32, 38]. Prior research suggests that if the family caregivers can actively engage with the medical decision-making process, it can significantly enhance the ICU patients' final outcomes [15].

However, caregivers often find it challenging to access and understand the necessary clinical information to make informed decisions on behalf of their care recipients in the ICU [3, 25, 53]. Firstly, caregivers can only access limited information about the ICU patients, as they cannot enter the ICU ward frequently, their older adult patients are often unable to talk to them due to unconsciousness, and they primarily rely on the ICU clinical team, who are already overwhelmingly busy, to fetch information [7, 32, 59]. Secondly, caregivers often find it difficult to fully understand the highly specialized medical language or results due to their low level of health literacy [79]. To address these challenges, various solutions have been proposed, yet mostly centered on the ICU clinical team side to innovate their best practices: for example, ICU clinicians are recommended to communicate more frequently with caregivers [57], and they may use a checklist or a daily-goal form to present more complete clinical information and in a more understandable way to caregivers [9, 13, 49, 58]. However, these best-practice recommendations fail to meet the caregivers' information needs [17, 26, 45], and we need novel caregiver-centered perspectives and technical solutions to support this need.

Researchers in Human-Computer Interaction (HCI) and Computer-Supported Cooperative Work (CSCW) have proposed and examined various technological solutions to support caregivers' information needs [18, 30, 36, 50]. One group of works designed new tools to facilitate clinicians sharing information with caregivers [30, 75] and caregivers seeking clinical information of older adult patients [47, 70]. Another group of works focused on the development of visualization tools to decipher complex clinical information to support caregivers' understanding (e.g., a visualization dashboard for caregivers to understand autism children's behaviors [42] and a dashboard for caregivers to support patients' upper-limb stroke rehabilitation therapy process [56]). However, these designs still fall short in the ICU context: as these tools are not tailored to support caregivers' information needs in high-stakes and time-sensitive ICU settings; and the complexity and density of information generated by the ICU environment can easily overwhelm caregivers in comparison to the other contexts, thus, the proposed visualization dashboards may not be enough to support them to understand complex patient information.

Recent advancements in artificial intelligence (AI) have opened new possibilities to help family caregivers better access and easily understand clinical information. For instance, AI models demonstrate great potential to extract relevant information from massive and unrelated raw clinical data from electronic health records (EHRs) [31], and AI can also help translate complicated medical jargon into simplified language for the general audience to understand [69, 73, 76]. In

addition, chatbot systems powered by large language models (LLMs) can support caregivers' individualized information-seeking requests in real time [2]. However, it remains underexplored whether and how these AI-based technologies may effectively support caregivers' information needs while their older adult patients are in the ICU. To this end, we propose this study to focus on exploring the information needs of caregivers of ICU older adult patients and designing novel AI functionalities to support their needs within the critical care environment. Specifically, our study aims to answer the following two research questions (RQs):

- **RQ1:** What challenges do family caregivers of older adult patients face in accessing and understanding clinical information in critical care settings?
- **RQ2:** How can AI-driven systems be designed to support caregivers' information needs in critical care settings?

We conducted a two-stage study to address these research questions. First, we conducted a formative study consisting of semi-structured interviews with 11 caregivers to understand the challenges they encountered in how they access and understand clinical information in critical care settings. Caregivers reported the primary difficulties come from fragmented clinical information updates, complicated clinical reports with limited or no explanations available, and frustration caused by repetitive but ineffective communication with the clinical team. Building on these findings, we derive a suite of design guidelines and synthesize an AI-based prototype with two key functionalities: a visual timeline of patients' medical events to support streamlined access with systematic patient status updates and an LLM-based chatbot to facilitate personalized information inquiries through versatile text-based conversations. We then conducted usability evaluations with six family caregivers to assess the prototypes. Qualitative analysis reveals the promising opportunity of leveraging AI to support caregivers' access and understanding of complex medical information, reduce cognitive burdens, and enhance engagement with care provider teams.

This work makes the following contributions. We systematically investigated the challenges caregivers of older adults encountered in accessing and understanding clinical information in critical care settings. We presented a suite of design guidelines to support the design of caregiver-facing interfaces with advanced AI technologies and evaluated two AI-based functionalities designs. Finally, our findings contribute to the broader discourse on technology-mediated caregiver support and the role of AI in supporting caregiving experiences for family caregivers in high-stakes, time-sensitive critical care scenarios.

2 Related Work

2.1 Family Caregivers of Older Adults in Critical Care Settings

In the United States, over half of ICU admissions involve older adults aged 65 and above [23]. This population is receiving growing attention due to their complex health needs, which are often compounded by chronic diseases and acute health crises [34]. When older adult patients are unable to talk or are unconscious due to severe injuries, family caregivers of older adults have to actively engage in the care process [7, 38]. For instance, family caregivers could be assigned powers of attorney to make critical decisions on behalf of their loved ones [32]. On the other hand, they must prepare for the patient's post-discharge care by coordinating the necessary support with healthcare providers, as caregiving demands often continue or escalate following patients' ICU discharge [16]. The demanding responsibilities of family caregivers often place an immense burden on them, which is often compounded by the difficulties of accessing and understanding medical information in the ICU.

However, caregivers are often not familiar with the critical care environment and only possess limited health literacy, which causes significant difficulty for them in understanding the overwhelming and complicated critical care

situation. ICU wards impose restrictive visitation policies to avoid disruptions caused by the presence of unnecessary non-professional personnel [19, 65]. Such restrictions leave caregivers with difficulties in comprehensively accessing and understanding the patient's health condition and treatment progression in a timely manner. Moreover, caregivers experience deep anxiety and helplessness about their loved ones because of the sudden deterioration of older adults' health and are unable to anticipate what could happen to the older adults [35]. Studies report that up to 54% of family caregivers experience psychological trauma or severe stress after caregiving experiences in critical care situations [4].

Consequently, caregivers have to rely heavily on direct communication with healthcare providers to stay informed about the patient's status [78]. However, the provider teams are always overloaded with caring for critically ill patients and have very limited opportunities and time to talk with caregivers. Such constrained caregiver-provider communications can hardly meet caregivers' information needs. Research highlights persistent dissatisfaction among caregivers despite institutional efforts to improve clinical communication through tools like daily goals forms [57], critical care family satisfaction surveys [63], and allocation of additional resources to ICU wards [12]. Further, the lack of clear, timely, and actionable information heightens caregivers' stress and disrupts their ability to prepare for the patient's post-discharge care [8].

2.2 Technology Solutions to Support Family Caregivers in Clinical Settings

In recent years, the fields of Computer-Supported Cooperative Work (CSCW) and Human-Computer Interaction (HCI) have advocated for an ecological perspective on caregivers' information needs in clinical settings [55]. Research highlights the crucial role caregivers play in patients' care process and emphasizes their substantial responsibilities, such as monitoring care recipients and engaging conversations with care provider teams [62, 71].

Prior work identified a significant barrier that impedes the effective information sharing for family caregivers is the absence of a centralized data storage framework [1, 5]. Today's Electronic Health Records (EHR) systems, which are widely adopted by hospitals to support clinical information organization and storage, still suffer from critical limitations [61]. For instance, data in EHR often remain fragmented, making it difficult to be clearly organized and not possible to be understandable by non-experts [52]. Furthermore, EHR was primarily designed to document the data generated or recorded from the patients, but not necessarily capture the interactions between providers and the caregivers. For instance, clinicians may engage in important goals-of-care discussions with patients but fail to adequately document these interactions, which leads to difficulties when caregivers want to retrieve such information at a later time [44, 48].

In response, studies have contributed to research on deployment and analyzed how to leverage existing technologies to improve caregiver engagement in clinical information seeking and understanding. Additionally, the broader community has focused on improving communication practices and health literacy through tools designed to streamline data management and support stakeholder collaboration [55]. For instance, Kong et al. [42] developed a web-based tool to visualize the communication behaviors of children with autism during clinical visits, aiming to enhance caregivers' understanding of their condition and actively involve them in care planning. Hong et al. [33] designed an interactive system that helps families and clinicians review radiology imaging results by providing simplified definitions and diagrams of medical terms during consultations. Tunnell et al. [67] developed a personal health record (PHR) prototype for smartphones to improve communication efficiency between patients and clinicians by allowing easy retrieval of personal health information. However, while these technologies offer valuable support for the information gap in routine clinical settings, they are not fully equipped to handle the high-stakes, time-sensitive nature of ICU admissions for

older adults. Additionally, caregivers have predominantly been studied as ancillary stakeholders, primarily responsible for assisting clinical care rather than being recognized as active participants with critical roles in the care journey [11].

In conclusion, tools and technologies specifically designed to support older adult ICU patients and their caregivers remain limited. Existing solutions are fragmented in scope, which highlighted an urgent need of leveraging innovative technologies to systematically address caregivers' difficulties in accessing and understanding medical information in critical care settings.

2.3 AI-Supported Clinical Information Technologies

Recent advances in artificial intelligence (AI) algorithms and models have demonstrated transformative potential to enhance decision-making, streamline workflows, and improve outcomes for both patients and healthcare professionals in clinical settings. Researchers have successfully developed AI-based clinical pre-screening systems (e.g., for diagnostic triage) [74], risk prediction algorithms (e.g., for sepsis risk prediction) [64, 77], and automated information processing (e.g., EHR summarization) [18, 28, 50]. These innovations have primarily targeted healthcare providers to optimize clinical workflow efficiency and reduce clinicians' cognitive burdens in high-pressure environments [30]. Existing AI solutions in critical care settings prioritize clinical workflow optimization (e.g., predictive analytics for resource allocation) [30] and direct patient monitoring (e.g., AI-based vital sign analysis) [80].

A growing body of work has also explored patient-centered AI technologies, such as symptom-tracking chatbots [36], personalized treatment recommendation systems, and tools to improve patient-provider communication [75]. While these efforts emphasize clinical stakeholders and patients, they largely overlook the critical role of family caregivers, particularly in the ICU. In ICU contexts, caregivers serve as intermediaries between clinicians and patients, advocating for care preferences, interpreting complex medical information, and making time-sensitive decisions under significant emotional duress. Despite the critical role, their experiences and needs remain understudied in AI-based healthcare research. This gap is particularly problematic in ICUs, where caregivers must rapidly assimilate high-stakes information (e.g., prognostic uncertainty, treatment trade-offs) while coordinating with care provider teams.

The lack of focus on caregivers reflects a broader oversight in human-centered AI design: systems often fail to account for indirect end-users who lack formal medical training but bear responsibility for care decisions. For example, AI tools designed to improve clinician-patient communication [75] rarely consider how caregivers might misinterpret or operationalize AI-generated insights. This disconnect underscores an urgent need to reconceptualize AI systems as caregiver-facing tools, capable of distilling complex data into contextually relevant, emotionally sensitive, and ethically transparent guidance tailored to caregivers' literacy levels, cultural contexts, and decision-making autonomy.

3 Formative Study: Method

We conducted a formative study that aims to explore the challenges experienced by family members of older adult patients in critical care settings, particularly with respect to accessing and understanding clinical information, their coping strategies and limitations of existing supportive technologies. We recruited caregivers who had prior caregiving experience with older adults in the ICU and conducted semi-structured interviews with the participants to gain deeper insights into their interactions with information needs and technology uses in this high-stakes and high-risk context.

3.1 Participants

We recruited participants (N = 11) with prior experience of caregiving older adults in the ICU. Recruitment was conducted through convenience sampling [22] on social media platforms, including Twitter, Instagram, and Facebook.

Screening surveys in an online form were distributed via these platforms for prospective participants to fill out. The screening survey collected their demographic information and caregiving background details (See Table 1). Exclusion criteria included individuals who did not live in the United States, were under 21 years of age, could not speak English, and were not close family members of older adult patients.

3.2 Procedure

During the interviews, participants were asked to recall their experiences as family caregivers when their older family member was critically ill and admitted to the ICU. We asked participants not to disclose any identifiable personal information while sharing their experiences. Our focus was on the clinical information they received as caregivers and the challenges they encountered that are related to the clinical information. Building on their caregiving experiences, participants were also prompted to share their interactions with technologies that assisted their information-seeking process, if any. The detailed semi-structured interview protocol can be found in Appendix A.

The interviews were conducted remotely via Zoom and lasted approximately 40–60 minutes each. All sessions were audio-recorded and transcribed with participants’ consent. We employed an inductive approach to analyze the data [66]. Two researchers independently coded the transcripts, discussed and reconciled the initial coding schema, and iteratively refined it to ensure clarity and consistency. The finalized codebook was then applied across all transcripts by both researchers, with any disagreements resolved through discussion until a consensus was reached.

Table 1. Demographics of Participants and Their ICU Experiences: "N/A" indicates that participants chose not to disclose their personal information

P#	Gender	Age	Relationship to Patient	Patient Age
P1	M	30	Father	65+
P2	M	26	Mother	65+
P3	M	28	Grandmother	65+
P4	F	N/A	Relative	80+
P5	F	30	Mother	65+
P6	M	35	Father	67
P7	F	N/A	Step-Grandmother	73
P8	M	29	Father	65
P9	M	36	Uncle	75
P10	M	25	Father	65
P11	F	27	Uncle	65

4 Formative Study: Results

4.1 Caregivers’ Information-Accessing Challenges and Coping Strategies

Hard to capture patients’ changing status. Many interviewees (N = 8) expressed frustration about their limited access to patient information, which relied solely on verbal updates from the ICU healthcare team. This limitation stemmed from the care provider team’s demanding and tightly scheduled workflow, leaving caregivers overly dependent on sporadic conversations with clinicians for critical information. As P1 described, this experience often left him feeling like he was **left in the dark**: “There were times when I had to seek out doctors or nurses for updates,... I sometimes felt that my patients were seen as an interruption to the busy ICU schedule... on cases where I don’t get information, I don’t get to know what was going on,... I just felt I was left in the dark”.

The health status of patients admitted to the ICU could change drastically every second, but family caregivers often struggle to timely access the patient's health condition despite their prominent need to stay informed about the **patient's changing status**. Most caregivers have little to no prior experience in an ICU environment, making it challenging to grasp the patient's health condition in real time. P3, whose grandmother suddenly collapsed and was admitted to the ICU, described the shock and uncertainty of the experience: *"I would say the most challenging part is not knowing... what's really wrong with her. Like, before doctor actually came out to tell me [her condition], okay, some of the seizure and cardiac arrest [happened to her] ..., I was really perplexed... I'm really anxious about what could be happening"*. Some participants (N = 3) expressed a strong desire for consistent and timely updates from the healthcare team regarding the patient's condition. As they often need to juggle work responsibilities and cannot be at the hospital all the time, they emphasized the importance of accessible communication. However, this remains challenging, *"it's hard to get to know who's on the shift that day, and sometimes it you have to go there physically [to know his situation]"* (P4).

Some caregivers try to resolve this challenge by getting an overview of the patients' stay length in the ICU to piece together scattered details about their loved one's condition. *"so they told me that, ...it might be a short stay depends on [his condition, or] a longer stay, but considering that is another severe heart failure,[so] there's a possibility that it would be a longer stay. We should probably be more than a week at the ICU and just informing me about... like they might have to maybe perform another surgery if he... doesn't get responsive, and just telling me other treatment options, like ultra filtration that the end add transplants that might be considered if it isn't responsive"*(P6).

Struggling to align treatment goals with healthcare team. An extreme yet common issue reported by caregivers is their lack of information about the treatments the care recipients were receiving in the ICU. This gap in communication leaves many caregivers feeling excluded from critical decisions about their loved ones' care, creating a sense of helplessness and frustration. While most participants expressed trust in the clinicians' expertise and judgment, some (N = 3) had experienced situations where they were only informed after treatments had been administered, leaving no room for questions or understanding. P11 articulated this frustration: *"I was kind of curious to know the name of the drugs that it was taken at the moment, but then I think I wasn't given the opportunity to know"*. This lack of transparency, even for minor details, can undermine caregivers' confidence and intensify their anxiety.

In life-threatening situations, the lack of detailed explanations of ongoing treatments exacerbates caregivers' concerns, when their loved ones undergo **key treatments** (e.g., connected to multiple life-sustaining machines). Such visuals can be overwhelming particularly when the purpose of the interventions remains unclear. P1 shared their distress upon witnessing these scenes: *Because I felt when I see him connected with so many machines, I was like, what's happening. So at some point I want to know, why are they connecting? Why they did such machines on him? I didn't get to get that information from them. So basically they just told me, does the vital signs are okay, He's responding to treatment..."*.

These moments of uncertainty highlight a critical disconnect between caregivers and the healthcare team regarding key treatment goals, as caregivers' need for clarity is often overshadowed by the clinical priorities of medical staff. This lack of information leaves caregivers sidelined and unable to fully align the ongoing treatment with the healthcare team.

Managing Medical Terms Leading to Information Overload. The concept of being "lost in translation" is often discussed in relation to the medical terminology caregivers encounter. From our interviews, we identified two primary sources contributing to this challenge, which frequently leads to information overload: verbal communication with clinicians and the interpretation of written medical reports. While conversations with healthcare providers often

involve complex and unfamiliar language, caregivers typically have the opportunity to seek clarification from doctors. In contrast, medical reports present an even greater obstacle, with their technical content often leaving caregivers confused and searching external resources for explanation.

Caregivers frequently struggle to navigate the medical terms they encounter when trying to understand lab test results or their loved one's condition. The heavy use of technical jargon compounds their confusion, leaving them feeling overwhelmed and disconnected. As P4 remarked, "*some doctors tend to use ambiguous terms*". In many cases, caregivers feel compelled to ask clinicians for further clarification to make sense of the information shared with them. P5 described their experience: "*We couldn't understand some medical terms. So we asked him (the doctor) to use a clear word where he explained everything that is happening around...*". Similarly, P1 expressed their frustration, emphasizing how challenging it was to grasp critical information: "*because most of the information they give they speak in their big medical terms that I find it very difficult to grasp... I don't get hold of the information they were trying to pass to me because and they were not enough time for me to ask questions for that clarifications*".

Difficulty Constructing Meaningful Clinical Conversation. Caregivers often face significant challenges when trying to engage in meaningful conversations with the ICU healthcare team. These interactions can sometimes feel unproductive, as caregivers repeatedly ask unspecified questions but feel they receive vague or unclear responses. For some, the experience feels like "running in circles." P1 shared their frustration: "*At some point,...when I asked, [they just said] it is okay, we are doing our work, and his vital signs are okay, and they just tell me I should relax, not to bother myself about it...*".

In some cases, caregivers even refrain from asking questions altogether due to negative past experiences. P4 explained: "*Because there was this time I did ask the question, and I was told, even if I did explain to you, you wouldn't understand. Just believe that we are doing this for the good of your relative. You see, so for someone who's afraid to know what they should actually know, [their choice] is not going to ask questions, which is very wrong...*". Such interactions discourage open dialogue and can prevent caregivers from gaining critical information about the patient's care.

To navigate these challenges, some caregivers adopt proactive strategies, such as preparing their questions in advance. This approach helps them feel more confident and ensures they make the most of their limited opportunities to speak with clinicians. P7 described their method: "*[I'll prepare] my question so depend on what I see the day I visit her... let's say if I go like today, and then I notice a change when I get home, I'll prepare the question. I'll write what I would like to ask the doctor. So if I go the next day, I can just walk straight to the doctor's office and ask the question. The question said... depends on how mode the changes in our body, in our system and our behavior*".

Existing Digital Tools Offer Support, but Remain Incomplete. In our interviews, caregivers identified three primary digital tools they relied on during the period when their older adult patients were in the ICU: search engines (e.g., Google), conversational agents (e.g., ChatGPT), and patient portals, which are commonly provided apps for accessing medical information such as lab results, appointment summaries, and doctor's notes. While these tools offered varying levels of support, caregivers noted significant limitations that prevent them from fully addressing their needs.

Caregivers often turned to search engines and conversational agents for quick access to information, such as definitions of medical terms or procedural details. However, the quality and relevance of the information obtained varied widely, leaving many feeling dissatisfied. For instance, P2 described encountering conflicting and overly simplified information when using search engines: "*when I search online, sometimes the the information shows] conflict, yes, the conflict...it's good possibility. It's really show just minor information... the visiting hours, everything, the equipment used, visiting hours, the policies, like, it's just like minor information*".

Patient portals emerged as another widely used tool, offering caregivers direct access to clinical information such as lab results, medical summaries, and doctors' notes. P6 highlighted the utility of patient portals in tracking and reviewing medical updates: "[I use the patient portal to access] like his lab results, all the results get from the testing that we've done and the summaries that the doctors have provided the doctor's notes and all that from previous doctor's appointment". However, the utility of these portals often depended on the caregiver's ability to interpret the information. For P8, the portal was only helpful for making basic assessments, such as identifying whether a symptom was mild or serious: "Then I didn't use it for all...[unless] maybe when he feels somehow, and I would perform a particular test, and I actually use that information to actually see if it is something alarming or maybe just a mild thing, maybe due to the fact that he sleeps on one side, maybe that's the cause".

4.2 Design Guidelines: Translating Caregiver Needs into Action

From the challenges and strategies shared by caregivers, several key areas emerge where technology can be enhanced to better support their needs, we derived three design guidelines to shape our prototype: **centralizing patients' status updates, simplifying medical terminology with tailored granularity, and fostering more meaningful communication with ICU teams.**

- **DG1: Centralize sequential patient status updates:** Develop tools that aggregate real-time treatment progress, lab results, and predictive trajectories (e.g., potential surgeries or therapies) into a unified dashboard. This reduces reliance on fragmented verbal updates and empowers remote monitoring.
- **DG2: Demystify medical terminology with tailored granularity:** Integrate AI-powered tools that translate jargon into context-aware, EHR-linked explanations. These systems should adapt to caregivers' expertise levels, reducing dependency on external searches or clinician cross-validation.
- **DG3: Facilitate structured clinical conversations:** Deploy conversational agents that suggest context-relevant questions (e.g., post-consultation clarifications) and scaffold dialogue frameworks. As noted in Section 4.1, this aligns with caregivers' practices of note-taking while mitigating cognitive overload.

5 Evaluation Study: Method

5.1 Synthesizing into Design Prototype

Building on the design space in Section 4.2, we developed a low-fidelity prototype to address caregivers' critical needs through two interconnected components: a medical timeline contextualizing the patient's ICU stay and an AI-based chatbot offering in-situ knowledge support (see Figure 1).

Medical Timeline of Patient's ICU Stay (Fig. 1 (A)): This interface is composed of fragmented clinical data into a unified narrative, structured to scaffold caregivers' understanding of dynamic care trajectories (**DG1**). The top section features a chronological timeline highlighting critical milestones (e.g., ventilator placement and antibiotic changes), enabling caregivers to track progress and anticipate care transitions. Below, a daily overview organizes information into three purpose-driven modules: (1) *AI-generated summary* synthesizes lab results (e.g., trending creatinine levels) into plain-language insights, reducing cognitive load in parsing raw data; (2) *Treatment for the Day* details interventions (e.g., medication schedules with purpose explanations) and key procedures, fostering transparency in clinical workflows and (3) *Goals for the Day* outlines actionable priorities (e.g., "Monitor blood pressure stabilization"), aligning caregivers with care-team objectives to mitigate feelings of exclusion.

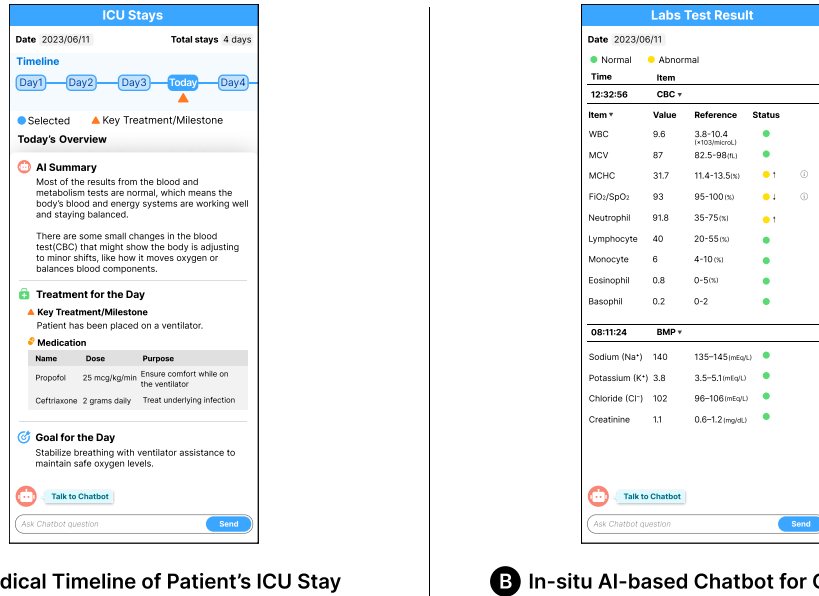

Fig. 1. Low-Fidelity Prototype Designs: (A) A medical timeline visualizing a patient's ICU stay, highlighting key treatments, medications, and daily goals. (B) Example of an in-situ, AI-assisted lab test interpretation system, where a chatbot delivers real-time insights into medical reports, helping users understand test results and trends.

AI-Based Chatbot (Fig. 2): The chatbot supports caregivers through three context-aware functionalities, bridging gaps between clinical data and actionable understanding (DG2). *Fact Finder*(Fig. 2 (A)) delivers clinician-vetted explanations to direct queries (e.g., clarifying ventilator necessity as “supporting oxygen exchange during lung recovery”), while suggesting follow-up questions (e.g., “Signs indicating ventilator removal?”) to scaffold proactive advocacy. *Data Interpreter* (Fig. 2 (B)) demystifies complex metrics (e.g., explaining elevated MCHC as “potential dehydration or blood cell irregularities”) and contextualizes their relevance to the patient's condition, pairing interpretations with guided prompts like “Ask about related lab results.” Lastly, *Intention Prompter* (Fig. 2 (C)) structures caregiver-clinician dialogue by generating tailored questions and organizing guidance into themes like “Prepare for the Future” or “Learn What You Can Do,” addressing caregivers' need for structured agency in chaotic environments (DG3).

5.2 Participants and Procedures

We recruited the same six caregivers from Section 3 to conduct a heuristic evaluation of our system. To comply with usage regulations requiring approval for accessing MIMIC-III [37] data, we integrated de-identified, synthesized patient data into our prototype. In this paper, we present only mock data to illustrate the user interface.

For each design concept, we allocated 10–15 minutes for participants to explore its potential applications. After an introduction to each interface, participants were encouraged to interact with its features, share their impressions, and evaluate its usefulness in tracking a patient's status. They also discussed how they might have used the tools to access and interpret medical information, which aspects were most helpful, and what improvements could enhance usability. A detailed semi-structured interview protocol is provided in Appendix B.

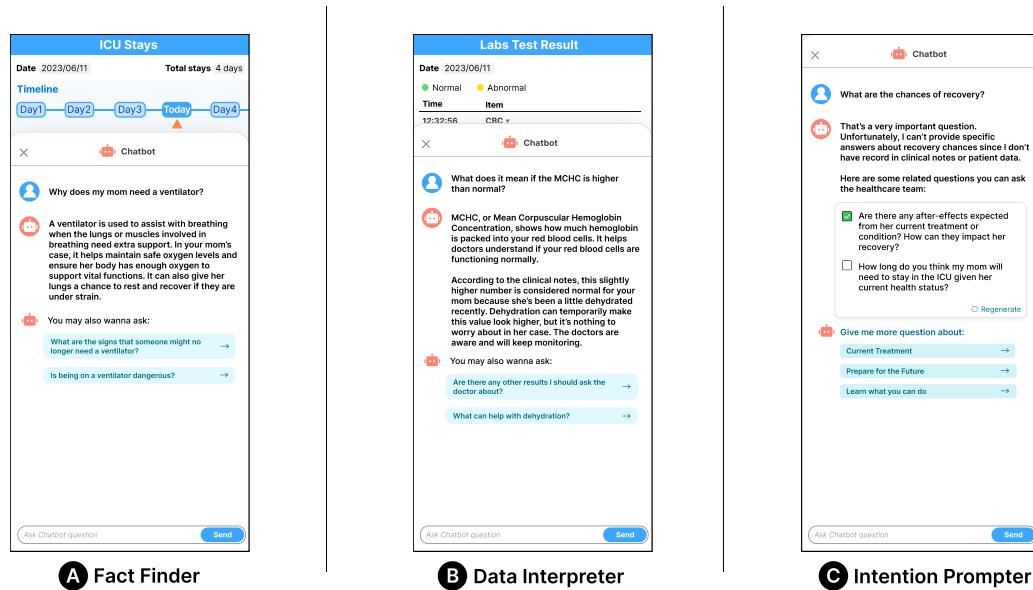

Fig. 2. Chatbot Prototype Design for Healthcare Q&A: (A) Fact Finder – Answers user queries about ICU treatments and suggests follow-up questions; (B) Data Interpreter – Explains lab test results with clinical context, and (C) Intention Prompter – Helps users formulate meaningful questions for healthcare providers.

The interviews were conducted remotely via Zoom, with each session lasting approximately 30–45 minutes. All sessions were recorded and transcribed with participant consent. Two researchers independently analyzed the transcripts using inductive process [66], identifying key insights related to usability and the perceived impact of each prototype.

6 Evaluation Study: Results

This study seeks to evaluate and contextualize the impact of our proposed prototype, which was developed to address the technological and informational challenges uncovered in formative study. This section brings together family caregivers' feedback on each of our prototypes, focusing on two key aspects: how well it supports their caregiving experience and what can be improved through further design refinements.

6.1 Medical Timeline of Patient's ICU Stay

Overall, our participants found the centralized timeline view to be a valuable tool for supporting the sense-making of dynamic patient status changes during ICU stays. Building on findings from formative study, which revealed that caregivers struggle with inconsistent information structuring and accessibility in ICU workflows, the timeline interface directly addresses a critical gap: caregivers often rely on fragmented clinical communications, making it challenging to synthesize a holistic understanding of a patient's condition and treatment trajectory. A unified interface that visualizes patient progress over time could address this gap by enhancing caregivers' **situational awareness**—enabling them to track trends, identify critical events, and make timely decisions. For example, P6 emphasized the timeline's utility in

contextualizing patient trajectories, noting: “It (*The medical timeline*) should be helpful to monitor the progress, and if it’s deteriorating or it is the treatment is being progressive...”

The timeline’s value extended beyond individual sense-making to **collaborative communication**. Participants highlighted its role in bridging information asymmetries between the individual family caregivers and other family members by serving as a patient-centered communication tool for sharing updates. P6 described its dual function for personal tracking and family engagement: “When I want to know, like the progress, so mostly when I guess it’s just trying to monitor the world situation. So it’s like every time I want to check out the like, it’s progress, or every time I want to, like, send some results to my siblings, I would try to use the tab and just saying, this is this progress chart” (P6).

Additionally, the timeline **mitigated information overload**—a pervasive issue in data-dense ICU environments—by structuring complex clinical data into temporally organized, actionable insights. This design reduced cognitive effort, allowing caregivers to focus on deeper analysis rather than data aggregation. As P7 noted, the interface supported ad-hoc, needs-driven inquiry: “[I] might not be daily [to check on that information], but anytime you want to really know about what is really wrong, to have more understanding [on the patient’s status], you just look at it”.

6.1.1 Make AI-generated Summaries Balancing Simplicity and Depth. AI-generated summaries of patient statuses, while effective for providing family caregivers with a rapid overview, also revealed the need to balance actionable simplicity with contextual depth. Participants acknowledged the utility of streamlined summaries for initial orientation—particularly in high-stress ICU environments where cognitive load is a pressing concern. However, they emphasized that oversimplification risked stripping away medically relevant context, hindering their ability to interpret care decisions or advocate meaningfully for patients. For instance, P10 stressed the necessity of integrating prior medical history into summaries to contextualize acute conditions, noting: “Any [other] information I would like to see there was, like, personal information about the patient... What I’m talking about is the previous illness of the patient... if the patient is having any other illness, any other disease”. Similarly, caregivers sought granular, actionable insights behind high-level summaries, such as interpretations of diagnostic test results. As P7 argued, “[I want to know more details about] after the test is conducted, either blood test or any test, what they found out after tests”.

6.1.2 Shared Goals and Care Keeping Caregivers Connected. For caregivers who cannot always be physically present in the ICU, access to real-time, granular details about their loved one’s daily treatments is critical for maintaining a sense of connection and involvement in care. While an interface that outlines medications, dosages, and administration schedules enables caregivers to stay engaged remotely, many participants (N = 4) expressed needs for even deeper levels of transparency to align their emotional and logistical priorities with the care process. For instance, caregivers emphasize the importance of precise timing for drug administration, as highlighted by P7: “... because even if I’m not around, maybe due to the work purpose, or any situations I could actually know the medication that is actually planned for the day, the dosage. And I do feel like, if possible, the time for this administ to administer the drugs was actually there. It would have been a little bit better, maybe in case of times where I feel like I want to be there when this particular drugs is being administered, and if the time was actually there, I feel like it would have been better...”

Beyond logistical clarity, caregivers also seek insight into the broader arc of care, including how treatments correlate with patient progress. P9 highlighted this need, noting that understanding expected outcomes helps contextualize daily interventions: “Yeah. It[the goals] like the kind of results (improvements) that we should be expecting, that’s the only thing I noticed”. Similarly, P10 stressed the value of linking treatments to patient responses: “[besides providing the treatment, I want to know] how he is responding to treatment, [based on] the kind of treatment has been given that day, and the activities of the day”.

6.2 Chatbot

Participants widely endorsed the AI-based chatbot as a vital tool for delivering timely, in-situ knowledge support within the ICU care ecosystem. The chatbot's ability to synthesize complex medical information into accessible, context-aware responses resonated with caregivers seeking immediacy and reliability. P6 underscored its alignment with modern technological expectations, noting: *I think it (the chatbot) helps to understand the system's information, and it's something that... readily available, so it's very helpful...And I think that everyone would use such feature, because right now AI is like a big part of everyone's daily life, so it's something that everyone would be keen to using and trusting*".

6.2.1 Fact Finder: Delivering Reliable, On-Demand Information. Caregivers prioritized the need for accurate, instant explanations of ICU protocols, equipment, and treatments—a demand met by the chatbot's Fact Finder feature. By distilling technical medical concepts into concise, actionable answers, this functionality reduces ambiguity and empowers caregivers to make informed decisions. For instance, when queried about ventilator use, the chatbot might explain how the device stabilizes oxygen saturation and promotes lung healing, translating abstract mechanisms into tangible patient benefits. The value of this immediacy was emphasized by P8, who described how Fact Finder mitigates delays in understanding urgent care decisions: *it actually helps. It helps because there are times whereby you want, you have, you come back, you meet a particular team being administered easily. You can actually, instead of waiting to see a doctor to actually explain, you could actually just use the portal to know the reason why a particular equipment or a particular thing is actually administered*".

6.2.2 From Complexity to Comprehension: Data Interpreter in Action. Medical data, often dense with jargon and numerical thresholds, can alienate caregivers unfamiliar with clinical terminology. The Data Interpreter addresses this challenge by contextualizing lab results, vital signs, and diagnostic metrics within the patient's unique care trajectory. When confronted with an elevated MCHC level, for example, the chatbot deciphers the acronym, explains its role in assessing blood health, and links abnormalities to potential symptoms or treatment adjustments. This feature also fosters trust by proactively flagging inconsistencies. P7 praised its capacity to detect and clarify potential errors, stating: *“Yeah, if it is from the test that was carried out, if there is, um, kind of mistake somewhere with the digits the number, but the chat votes indicates that there was a mistake, or to just give it answer based on the digits or the numbers that's provided, That's good[if it will identify the mistake and tell you,]”*.

6.2.3 Preparing for the Future: How Intention Prompter Supports Proactive Care. Beyond reactive support, the Intention Prompter equips caregivers to anticipate and navigate future care milestones. By generating contextually relevant questions—such as inquiries about post-discharge mobility aids or rehabilitation plans, the system transforms passive observers into proactive advocates. P7 illustrated this shift, explaining how prompts about crutches or wheelchair readiness shaped their preparedness: *“Yeah, [these catpgoes] Then you can actually know that what to prepare for in the future, maybe is going to use crutches or is going to use a wheelchair. Then it's actually helped me to know what you actually do to actually support at that point. So it's actually very good.”*

The feature also structures communication with clinicians, ensuring caregivers retain critical information during consultations. P6 emphasized its role in mitigating cognitive overload: *“Just the questions here would help with like I mentioned, help me prepare questions... because the doctor mentioned so many things that I wouldn't even recall. I wouldn't even understand. But if I had prepared my question before and after, doctor answered, then it helps me understand the situation”*. Similarly, P10 noted its role in safeguarding against oversight, even amid fluctuating conditions: *“it will help me like, if we have the doctor to give me there certain answer that I needed. Although there might be changes in this.*

That’s what I say. I can be, there might be improvement on my own, but I was ... of this kind of question. cause, yeah, this question is poses important”.

7 Discussion

We begin by discussing the potential of our prototypes to reposition family caregivers as integral contributors in clinical settings, moving beyond their traditional role as ancillary stakeholders (Section 7.1). Next, we outline key design considerations for future systems that support family caregivers in clinical settings for older adult patients (Section 7.2). Finally, we highlight ethical, socio-technical, and privacy concerns associated with the use of technology and AI in real-world implementations (Section 7.3). Finally, we present the limitations of our work and suggest directions for future research (Section 7.4).

7.1 Beyond Ancillary Roles: Empowering Caregivers as Informal Healthcare Partners

Our formative study underscores the information needs of family caregivers of older adult patients in critical care settings. It reveals how unmet information needs often leave caregivers feeling excluded in crucial clinical situations for their loved ones, despite their strong desire to provide care. Traditionally, research has framed family caregivers as “proxies” or ancillary stakeholders, primarily responsible for assisting clinical care rather than actively contributing to it [11, 21, 24]. Their potential to improve health outcomes has been understated, as they are often perceived as supporting actors rather than integral participants in the care process. This dynamic is especially pronounced in ICU settings, where caregivers frequently act as advocates for critically ill patients who cannot communicate for themselves [7]. Despite this critical role, their contributions are often undervalued, and their integration into the care ecosystem remains limited.

Recognizing the critical role of familial involvement, recent healthcare research has increasingly acknowledged the importance of integrating family caregivers into clinical settings, proposing frameworks such as family-centered care (FCC) [14, 20, 39] and practices to institutionalize their participation. For instance, initiatives in chronic care and neonatal contexts have demonstrated how structured family engagement can improve patient outcomes and care continuity [43, 72]. In parallel, research in Computer-Supported Cooperative Work (CSCW) and Human-Computer Interaction (HCI) has adopted an ecological lens to investigate the socio-technical ecosystems surrounding family caregivers in clinical settings. Empirical studies have systematically mapped caregivers’ multifaceted roles—from emotional anchoring to logistical orchestration during hospitalizations [10, 46, 54]—while others have designed technologies to scaffold their caregiving labor [40, 51, 60, 61]. For example, Miller et al. [46] delineates how family caregivers navigate fragmented hospital workflows, often compensating for systemic gaps in care coordination. Kong and Karahalios [41] developed a real-time communication platform that bridges family caregivers and clinicians, enabling collaborative interpretation of patient data through shared visualizations. These efforts reflect HCI’s growing emphasis on relational infrastructure: designing systems that amplify family caregivers’ agency while fostering equitable collaboration within clinical hierarchies.

Our study advances this discourse by positioning family caregivers as primary stakeholders in critical care ecosystems, challenging their historical framing as peripheral actors. While prior CSCW work has focused on clinical information gathering as a transactional process, our findings reveal how technology can empower caregivers through participatory roles—not just as passive recipients of information, but as active collaborators in care coordination. For instance, Our prototypes feature a context-aware, in-situ chatbot that empowers caregivers by (1) enabling up-to-date, centralized tracking of patients’ evolving health data (e.g., vital signs, medication changes) to ensure consistent monitoring and (2) simplifying complex medical terminology via just-in-time, context-aware explanations tailored to caregivers’ situational

needs. Such tool bridges communication gaps between clinical teams and familial advocates by surfacing actionable insights while aligning with CSCW’s focus on distributed collaboration—enabling asynchronous, yet coordinated, care coordination. By embedding equity into the design (e.g., simplifying jargon for diverse health literacies), the chatbot fosters inclusive participation in care ecosystems, ensuring caregivers are not just informed but active co-interpreters of patient data.

While our work demonstrates the potential of technology to mitigate caregiver exclusion, it also surfaces critical tensions in scaling these interventions. For example, continuous patient-status tracking—though vital in critical care—may inadvertently exacerbate caregiver anxiety or cognitive overload in chronic care contexts, where stability (rather than volatility) dominates. Drawing on HCI’s focus on context-aware design, we argue against one-size-fits-all solutions. Instead, systems must adapt to the temporal and emotional rhythms of caregiving: acute, high-stakes scenarios demand real-time transparency, while chronic contexts may prioritize longitudinal trend analysis or selective information filtering. We advocate for modular, customizable systems that reflect the situated realities of caregiving. Rather than universalizing caregiver needs, technologies should be designed through participatory, value-sensitive approaches—particularly for conditions where caregiver-clinician collaboration is critical (e.g., dementia, and post-operative care). This necessitates balancing transparency with situated ethics, such as designing for selective data sharing to protect caregiver-patient privacy or integrating “pause” features to mitigate surveillance fatigue. We advocate for designs that empower caregivers while preserving clinical expertise, emphasizing technology’s role in mediating socio-technical tensions.

7.2 Design Implications for Future Systems

Our research demonstrates AI systems can meaningfully support family caregivers in high-pressure clinical environments (e.g., ICU) through two key interventions: 1) centralized patient data and 2) real-time AI guidance grounded in clinical evidence. Findings from evaluation study revealed this approach reduces caregivers’ cognitive burden and anxiety when navigating rapidly changing health data, particularly when reconciling critical status updates under time-sensitive conditions.

Based on our findings, we propose a series of design considerations to guide the development of AI-based, family-centered clinical information systems in real-world healthcare settings. Specifically, we explore how the domains of Human-AI collaboration, computational machine learning, and CSCW can leverage their foundational research challenges to advance support for family caregivers.

From the perspective of **Human-AI Collaboration**: family caregivers face immense cognitive demands in high-stakes clinical environments, where tasks like interpreting lab results, decoding medical jargon, and synthesizing fragmented verbal updates require situational awareness they often lack due to limited medical training. This challenge is compounded by emotional stress, creating a critical need for AI systems that act as collaborative partners rather than mere data tools. Through participatory design sessions, caregivers highlighted how AI could streamline clinical workflows by offloading cognitive labor — for instance, transforming raw EHR data into interpretable summaries, generating context-aware prompts for clinician interactions, or flagging urgent trends in patient status. Crucially, future systems should move beyond passive automation, instead fostering agency-preserving collaboration, where AI serves as a “thought partner”— clarifying uncertainties and providing guidance without overriding caregivers’ autonomy in decision-making. The success of prototypes like our fact-based chatbot — which reduced anxiety by delivering just-in-time explanations of medical changes — underscores the importance of balancing automation with user control. Future systems must deepen this synergy by integrating EHR data and adaptive personalization, tailoring support not

only to caregivers' literacy levels but also to evolving clinical contexts (e.g., escalating ICU crises versus stable recovery). By framing AI as a translational layer that bridges medical complexity and caregiver understanding—while embedding stress-informed features like contextualized alerts—these tools can mitigate emotional-cognitive overload and foster trust, aligning with HCI principles of human-AI co-sense-making in critical environments.

From the perspective of **CSCW**: ICU caregiving is inherently collaborative yet paradoxically isolating—families often feel excluded from clinical workflows dominated by the ICU's fast-paced, protocol-driven rhythms. CSCW research offers pathways to scaffold collaboration within fragmented socio-technical ecosystems by designing shared sense-making infrastructures that bridge institutional hierarchies and fragmented data streams. For instance, integrating family-authored annotations (e.g., observations about a patient's pain responses) directly into electronic health records could democratize participation in care planning, as seen in our study where caregivers sought to contextualize clinical data with lived insights. Crucially, while AI cannot replace the nuanced explanations and relational labor of human healthcare teams, it can augment collaboration by structuring communication and mediating role conflicts. Future systems might leverage AI to clarify boundaries in real-time — such as surfacing prompts like *“Only physicians can adjust ventilator settings, but you can track sedation levels here”* during family-clinician interactions — while also fostering a unified narrative through interfaces like dynamic patient timelines. These timelines could visualize care milestones, family observations, and clinical updates in a single space, reducing ambiguity and aligning stakeholders. By blending AI's capacity for boundary negotiation with human-centered design principles, such systems could transform isolation into inclusive collaboration, prioritizing relational transparency and trust in high-stakes care environments.

7.3 Ethical, Socio-technical, and Privacy Concerns

Our study focuses on designing caregiver-facing AI tools for critical clinical environments, without extending to clinician-facing or patient-facing technologies. However, our findings reveal several ethical, socio-technical, and privacy risks that necessitate proactive mitigation before real-world deployment. Addressing these challenges requires frameworks that prioritize caregiver agency, transparent human-AI collaboration, and contextual adaptability within high-stakes care ecosystems.

A central tension emerges from AI's dual role as both a support mechanism and a potential stressor. Caregivers in our study acknowledged that AI tools could streamline tasks such as tracking patient status trends but expressed concerns about information overload—particularly when data required frequent, non-essential monitoring. This aligns with broader HCI discussions on trust in automated systems, where the absence of mechanisms for interrogating or contextualizing AI outputs can lead to trust erosion. To mitigate this, AI design must emphasize explainability—for instance, providing plain-language justifications for alerts (e.g., *“This oxygen saturation drop correlates with recent medication changes”*)—while ensuring that caregivers retain ultimate control over decision-making.

Privacy concerns were equally salient, particularly given caregivers' intermediary role in managing sensitive patient data. Participants recalled prior ICU experiences as information-dense and high-pressure, highlighting the need for auditable, privacy-preserving data practices. Future systems should integrate granular consent mechanisms (e.g., enabling caregivers to opt out of specific data-sharing features) and contextual anonymity (e.g., masking non-essential identifiers in shared interfaces) to align with HCI principles of privacy-by-design.

we advocate for AI systems that move beyond task automation to foster collaborative resilience. Achieving this requires embedding caregivers' lived experiences into the design process, ensuring that AI technologies amplify—rather than constrain—their capacity to navigate complex clinical realities.

7.4 Limitations and Future Work

Our study has several limitations that should be acknowledged. First, the scope of our participant pool was limited, with 11 participants in the formative study and 5 in the evaluation phase. While these participants provided valuable insights, the small sample size may limit the generalizability of our findings. Future research should aim to include a larger and more diverse group of caregivers to ensure broader applicability. Second, the prototype developed in this study is a proof-of-concept and has not been integrated with Electronic Health Record (EHR) systems or deployed in real-world clinical settings. While the prototype demonstrates the potential of AI-based tools to support caregivers, its effectiveness and usability in practical, high-stakes environments remain untested. Future work should focus on integrating such tools with existing healthcare infrastructures and evaluating their performance in real-world scenarios.

Additionally, our study specifically focused on designing a prototype to address caregiver-facing challenges. While this approach provides valuable insights into the needs of family caregivers, it does not fully account for the perspectives of clinicians or other stakeholders in the care process. Future studies should involve clinicians to explore how such tools can facilitate collaboration between caregivers and healthcare providers, ensuring that the design meets the needs of all parties involved. Lastly, while our research primarily addresses the ICU setting, there is a broader need to explore how similar tools can be adapted for other clinical environments. The challenges faced by caregivers in ICUs may differ from those in other settings, such as long-term care facilities or home-based care. Future work should delve deeper into these contexts to develop more versatile and context-aware solutions that can support caregivers across a wide range of healthcare scenarios.

8 Conclusion

This study investigated the information needs of family caregivers supporting older adults in critical care environments and designed AI-based prototypes to address their unique challenges. Through a two-stage participatory process, we uncovered the multifaceted complexity of caregivers' information workflows, particularly their struggle to reconcile dynamic patient health data (e.g., fluctuating lab results, medication changes) with fragmented clinical communication (e.g., jargon-heavy updates, asynchronous consultations). These challenges often exacerbated caregivers' sense of exclusion from care processes, leaving them ill-equipped to advocate effectively for their loved ones. Our prototypes—centered on AI-mediated tools for real-time data interpretation, contextualized communication support, and information scaffolding—demonstrated promising potential to empower caregivers. Evaluations revealed that these tools could enhance caregivers' situational awareness (e.g., Centralizing patient status information) and relational agency (e.g., generating plain-language questions for clinicians). However, participants also emphasized critical limitations: over-reliance on AI-generated summaries risked oversimplifying nuanced clinical contexts. These findings contribute to HCI research in healthcare, providing the foundation for designing inclusive, human-centered AI systems that amplify—rather than displace—caregivers' critical role in patient advocacy and care continuity.

References

- [1] Sherri Adams, Madison Beatty, Clara Moore, Arti Desai, Leah Bartlett, Erin Culbert, Eyal Cohen, Jennifer Stinson, and Julia Orkin. 2021. Perspectives on team communication challenges in caring for children with medical complexity. *BMC health services research* 21 (2021), 1–14.
- [2] Majid Afshar, Yanjun Gao, Graham Wills, Jason Wang, Matthew M Churpek, Christa J Westenberger, David T Kunstman, Joel E Gordon, Cherodeep Goswami, Frank J Liao, et al. 2024. Prompt engineering with a large language model to assist providers in responding to patient inquiries: a real-time implementation in the electronic health record. *JAMIA open* 7, 3 (2024), ooae080.
- [3] Abbas Saleh Al-Mutair, Virginia Plummer, Anthony O'Brien, and Rosemary Clerehan. 2013. Family needs and involvement in the intensive care unit: a literature review. *Journal of clinical nursing* 22, 13-14 (2013), 1805–1817.

- [4] Hanne Birgit Alfheim, Kristin Hofso, Milada Cvancarova Småstuen, Kirsti Tøien, Leiv Arne Rosseland, and Tone Rustøen. 2019. Post-traumatic stress symptoms in family caregivers of intensive care unit patients: A longitudinal study. *Intensive and Critical Care Nursing* 50 (2019), 5–10.
- [5] Ofra Amir, Barbara J Grosz, Krzysztof Z Gajos, Sonja M Swenson, and Lee M Sanders. 2015. From care plans to care coordination: opportunities for computer support of teamwork in complex healthcare. In *Proceedings of the 33rd annual ACM conference on human factors in computing systems*. 1419–1428.
- [6] Derek C Angus, Andrew F Shorr, Alan White, Tony T Dremsizov, Robert J Schmitz, Mark A Kelley, Committee on Manpower for Pulmonary, Critical Care Societies (COMPACCS, et al. 2006. Critical care delivery in the United States: distribution of services and compliance with Leapfrog recommendations. *Critical care medicine* 34, 4 (2006), 1016–1024.
- [7] Selena S Au, Amanda Roze des Ordons, Andrea Soo, Simon Guienguere, and Henry T Stelfox. 2017. Family participation in intensive care unit rounds: Comparing family and provider perspectives. *Journal of Critical Care* 38 (2017), 132–136.
- [8] Elie Azoulay, Nancy Kentish-Barnes, and Judith E Nelson. 2016. Communication with family caregivers in the intensive care unit: Answers and questions. *JAMA* 315, 19 (2016), 2075–2077.
- [9] Elie Azoulay, Frederic Pochard, Sylvie Chevret, Merce Jourdain, Caroline Bornstain, Anne Wernet, Isabelle Cattaneo, Djilali Annane, Frédéric Brun, Pierre-Edouard Bollaert, et al. 2002. Impact of a family information leaflet on effectiveness of information provided to family members of intensive care unit patients: a multicenter, prospective, randomized, controlled trial. *American journal of respiratory and critical care medicine* 165, 4 (2002), 438–442.
- [10] Andrea Barbarin, Tiffany C. Veinot, and Predrag Klasnja. 2015. Taking our Time: Chronic Illness and Time-Based Objects in Families. In *Proceedings of the 18th ACM Conference on Computer Supported Cooperative Work & Social Computing* (Vancouver, BC, Canada) (CSCW '15). Association for Computing Machinery, New York, NY, USA, 288–301. <https://doi.org/10.1145/2675133.2675200>
- [11] Karthik S. Bhat, Amanda K. Hall, Tiffany Kuo, and Neha Kumar. 2023. "We are half-doctors": Family Caregivers as Boundary Actors in Chronic Disease Management. *Proc. ACM Hum.-Comput. Interact.* 7, CSCW1, Article 111 (April 2023), 29 pages. <https://doi.org/10.1145/3579545>
- [12] Michael J Breslow and David J Stone. 2005. Technology strategies to improve ICU practice. In *Seminars in Anesthesia, Perioperative Medicine and Pain*, Vol. 24. Elsevier, 59–70.
- [13] Christine A Caligian, Diane L Carroll, Ann C Hurley, Ronna Gersh-Zaremski, and Patricia C Dykes. 2012. Bedside information technology to support patient-centered care. *International journal of medical informatics* 81, 7 (2012), 442–451.
- [14] COMMITTEE ON HOSPITAL CARE, INSTITUTE FOR PATIENT, and FAMILY-CENTERED CARE. 2012. Patient-and family-centered care and the pediatrician's role. *Pediatrics* 129, 2 (2012), 394–404.
- [15] JiYeon Choi, Youn-Jung Son, and Judith A Tate. 2019. Exploring positive aspects of caregiving in family caregivers of adult ICU survivors from ICU to four months post-ICU discharge. *Heart & Lung* 48, 6 (2019), 553–559.
- [16] JiYeon Choi, Judith A Tate, Leslie A Hoffman, Richard Schulz, Dianxu Ren, Michael P Donahoe, Barbara A Given, and Paula R Sherwood. 2014. Fatigue in family caregivers of adult intensive care unit survivors. *Journal of pain and symptom management* 48, 3 (2014), 353–363.
- [17] Judy E Davidson, Rebecca A Aslakson, Ann C Long, Kathleen A Puntillo, Erin K Kross, Joanna Hart, Christopher E Cox, Hannah Wunsch, Mary A Wickline, Mark E Nunnally, et al. 2017. Guidelines for family-centered care in the neonatal, pediatric, and adult ICU. *Critical care medicine* 45, 1 (2017), 103–128.
- [18] Bleiz Macsen Del Sette, Dawn Carnes, and Charalampos Saitis. 2023. Sound of Care: Towards a Co-Operative AI Digital Pain Companion to Support People with Chronic Primary Pain. In *Companion Publication of the 2023 Conference on Computer Supported Cooperative Work and Social Computing* (Minneapolis, MN, USA) (CSCW '23 Companion). Association for Computing Machinery, New York, NY, USA, 283–288. <https://doi.org/10.1145/3584931.3606971>
- [19] Laura Dragoi, Laveena Munshi, and Margaret Herridge. 2022. Visitation policies in the ICU and the importance of family presence at the bedside. *Intensive Care Medicine* 48, 12 (2022), 1790–1792.
- [20] Carl J Dunst and Carol M Trivette. 1996. Empowerment, effective helpgiving practices and family-centered care. *Pediatric nursing* 22, 4 (1996), 334–338.
- [21] Louise von Essen. 2004. Proxy ratings of patient quality of life Factors related to patient-proxy agreement. *Acta oncologica* 43, 3 (2004), 229–234.
- [22] Ilker Etikan, Sulaiman Abubakar Musa, Rukayya Sunusi Alkassim, et al. 2016. Comparison of convenience sampling and purposive sampling. *American journal of theoretical and applied statistics* 5, 1 (2016), 1–4.
- [23] H Flaatten, DW De Lange, A Artigas, D Bin, R Moreno, S Christensen, GM Joynt, Sean M Bagshaw, CL Sprung, Dominique Benoit, et al. 2017. The status of intensive care medicine research and a future agenda for very old patients in the ICU. *Intensive care medicine* 43 (2017), 1319–1328.
- [24] Pin Sym Foong, Charis Anne Lim, Joshua Wong, Chang Siang Lim, Simon Tangi Perrault, and Gerald CH Koh. 2020. "You Cannot Offer Such a Suggestion": Designing for Family Caregiver Input in Home Care Systems. In *Proceedings of the 2020 CHI Conference on Human Factors in Computing Systems* (Honolulu, HI, USA) (CHI '20). Association for Computing Machinery, New York, NY, USA, 1–13. <https://doi.org/10.1145/3313831.3376607>
- [25] Mina Gaeni, Mansoureh A Farahani, Naima Seyedfatemi, and Nooreddin Mohammadi. 2014. Informational support to family members of intensive care unit patients: the perspectives of families and nurses. *Global journal of health science* 7, 2 (2014), 8.
- [26] Michael J Goldfarb, Lior Bibas, Virginia Bartlett, Heather Jones, and Naureen Khan. 2017. Outcomes of patient-and family-centered care interventions in the ICU: a systematic review and meta-analysis. *Critical care medicine* 45, 10 (2017), 1751–1761.
- [27] Ana-Carolina Gonçalves, Annabel Williams, Christina Koulouglioti, Todd Leckie, Alexander Hunter, Daniel Fitzpatrick, Alan Richardson, Benjamin Hardy, Richard Venn, and Luke Hodgson. 2023. Surviving severe COVID-19: Interviews with patients, informal carers and health professionals.

- Nursing in critical care* 28, 1 (2023), 80–88.
- [28] Divya Gopinath, Monica Agrawal, Luke Murray, Steven Horng, David Karger, and David Sontag. 2020. Fast, structured clinical documentation via contextual autocomplete. In *Machine Learning for Healthcare Conference*. PMLR, 842–870.
- [29] Hakan Hanberger, Dominique L Monnet, and Lennart E Nilsson. 2005. Intensive care unit. In *Antibiotic policies: theory and practice*. Springer, 261–279.
- [30] Yuxing Hao, Corinna E. Löeckenhoff, Harry Lee, Jessica Zwerling, and Saleh Kalantari. 2024. The i-SDM Framework: Developing AI-based Tools in Shared Decision-Making for Cancer Treatment with Clinical Professionals. In *Companion Publication of the 2024 Conference on Computer-Supported Cooperative Work and Social Computing (San Jose, Costa Rica) (CSCW Companion '24)*. Association for Computing Machinery, New York, NY, USA, 134–140. <https://doi.org/10.1145/3678884.3681841>
- [31] Kristiina Häyriinen, Kaija Saranto, and Pirkko Nykänen. 2008. Definition, structure, content, use and impacts of electronic health records: a review of the research literature. *International journal of medical informatics* 77, 5 (2008), 291–304.
- [32] Sonia Hines, Judy McCrow, Jenny Abbey, Jenneke Footitt, Jacinda Wilson, Sara Franklin, and Elizabeth Beattie. 2011. The effectiveness and appropriateness of a palliative approach to care for people with advanced dementia: a systematic review. *JBI Evidence Synthesis* 9, 26 (2011), 960–1131.
- [33] Matthew K. Hong, Clayton Feustel, Meeshu Agnihotri, Max Silverman, Stephen F. Simoneaux, and Lauren Wilcox. 2017. Supporting Families in Reviewing and Communicating about Radiology Imaging Studies. In *Proceedings of the 2017 CHI Conference on Human Factors in Computing Systems (Denver, Colorado, USA) (CHI '17)*. Association for Computing Machinery, New York, NY, USA, 5245–5256. <https://doi.org/10.1145/3025453.3025754>
- [34] Carolyn Jarvis. 2023. *Physical Examination and Health Assessment-Canadian E-Book: Physical Examination and Health Assessment-Canadian E-Book*. Elsevier Health Sciences.
- [35] Ann L Jennerich, Mara R Hobler, Rashmi K Sharma, Ruth A Engelberg, and J Randall Curtis. 2020. Unplanned admission to the ICU: a qualitative study examining family member experiences. *Chest* 158, 4 (2020), 1482–1489.
- [36] Eunkyung Jo, Rachael Zehrung, Katherine Genuario, Alexandra Papoutsaki, and Daniel A. Epstein. 2024. Exploring Patient-Generated Annotations to Digital Clinical Symptom Measures for Patient-Centered Communication. *Proc. ACM Hum.-Comput. Interact.* 8, CSCW2, Article 458 (Nov. 2024), 26 pages. <https://doi.org/10.1145/3686997>
- [37] Alistair EW Johnson, Tom J Pollard, Lu Shen, Li-wei H Lehman, Mengling Feng, Mohammad Ghassemi, Benjamin Moody, Peter Szolovits, Leo Anthony Celi, and Roger G Mark. 2016. MIMIC-III, a freely accessible critical care database. *Scientific data* 3, 1 (2016), 1–9.
- [38] Susan K Johnson, Martha Craft, Marita Titler, Margo Halm, Charmaine Kleiber, Lou Ann Montgomery, Karen Megivern, Anita Nicholson, and Kathleen Buckwalter. 1995. Perceived changes in adult family members' roles and responsibilities during critical illness. *Image: the Journal of Nursing Scholarship* 27, 3 (1995), 238–243.
- [39] Jeremy Jolley and Linda Shields. 2009. The evolution of family-centered care. *Journal of pediatric nursing* 24, 2 (2009), 164–170.
- [40] Elizabeth Kazianas, Ayse G. Buyukturk, Jasmine Jones, Sung W. Choi, David A. Hanauer, and Mark S. Ackerman. 2015. Transition and Reflection in the Use of Health Information: The Case of Pediatric Bone Marrow Transplant Caregivers. In *Proceedings of the 18th ACM Conference on Computer Supported Cooperative Work & Social Computing (Vancouver, BC, Canada) (CSCW '15)*. Association for Computing Machinery, New York, NY, USA, 1763–1774. <https://doi.org/10.1145/2675133.2675276>
- [41] Ha-Kyung Kong and Karrie Karahalios. 2020. Addressing Cognitive and Emotional Barriers in Parent-Clinician Communication through Behavioral Visualization Webtools. In *Proceedings of the 2020 CHI Conference on Human Factors in Computing Systems (Honolulu, HI, USA) (CHI '20)*. Association for Computing Machinery, New York, NY, USA, 1–12. <https://doi.org/10.1145/3313831.3376181>
- [42] Ha Kyung Kong, John Lee, and Karrie Karahalios. 2017. A comparative study of visualizations with different granularities of behavior for communicating about autism. *Proceedings of the ACM on Human-Computer Interaction* 1, CSCW (2017), 1–16.
- [43] Dennis Z Kuo, Amy J Houtrow, Polly Arango, Karen A Kuhlthau, Jeffrey M Simmons, and John M Neff. 2012. Family-centered care: current applications and future directions in pediatric health care. *Maternal and child health journal* 16 (2012), 297–305.
- [44] Jennifer W Mack, Angel Cronin, Nathan Taback, Haiden A Huskamp, Nancy L Keating, Jennifer L Malin, Craig C Earle, and Jane C Weeks. 2012. End-of-life care discussions among patients with advanced cancer: a cohort study. *Annals of internal medicine* 156, 3 (2012), 204–210.
- [45] Kathleen L Meert, Jeff Clark, and Susan Eggle. 2013. Family-centered care in the pediatric intensive care unit. *Pediatric Clinics* 60, 3 (2013), 761–772.
- [46] Andrew D. Miller, Sonali R. Mishra, Logan Kendall, Shefali Haldar, Ari H. Pollack, and Wanda Pratt. 2016. Partners in Care: Design Considerations for Caregivers and Patients During a Hospital Stay. In *Proceedings of the 19th ACM Conference on Computer-Supported Cooperative Work & Social Computing (San Francisco, California, USA) (CSCW '16)*. Association for Computing Machinery, New York, NY, USA, 756–769. <https://doi.org/10.1145/2818048.2819983>
- [47] Sara Montagna, Stefano Ferretti, Lorenz Cuno Klopfenstein, Antonio Florio, and Martino Francesco Pengo. 2023. Data decentralisation of LLM-based chatbot systems in chronic disease self-management. In *Proceedings of the 2023 ACM Conference on Information Technology for Social Good*. 205–212.
- [48] Linda E Moody, Elaine Slocumb, Bruce Berg, and Donna Jackson. 2004. Electronic health records documentation in nursing: nurses' perceptions, attitudes, and preferences. *CIN: Computers, Informatics, Nursing* 22, 6 (2004), 337–344.
- [49] JE Nelson, CM Mulkerin, LL Adams, and PJ Pronovost. 2006. Improving comfort and communication in the ICU: a practical new tool for palliative care performance measurement and feedback. *BMJ Quality & Safety* 15, 4 (2006), 264–271.
- [50] Sarah Nikkhhah, Swaroop John, Krishna Supradeep Yalamarti, Emily L. Mueller, and Andrew D. Miller. 2021. Helping Their Child, Helping Each Other: Parents' Mediated Social Support in the Children's Hospital. In *Companion Publication of the 2021 Conference on Computer Supported Cooperative*

- Work and Social Computing* (Virtual Event, USA) (CSCW '21 Companion). Association for Computing Machinery, New York, NY, USA, 140–143. <https://doi.org/10.1145/3462204.3481759>
- [51] Sarah Nikkhhah, Akash Uday Rode, Priyanjali Mittal, Neha K. Kulkarni, Salonee Nadkarni, Emily L. Mueller, and Andrew D. Miller. 2022. "I feel like I need to split myself in half": Using Role Theory to Design for Parents as Caregiving Teams in the Children's Hospital. In *Companion Publication of the 2022 Conference on Computer Supported Cooperative Work and Social Computing* (Virtual Event, Taiwan) (CSCW'22 Companion). Association for Computing Machinery, New York, NY, USA, 115–120. <https://doi.org/10.1145/3500868.3559466>
- [52] Ann S O'Malley, Joy M Grossman, Genna R Cohen, Nicole M Kemper, and Hoangmai H Pham. 2010. Are electronic medical records helpful for care coordination? Experiences of physician practices. *Journal of general internal medicine* 25 (2010), 177–185.
- [53] Fiona Paul, Charles Hendry, and Louise Cabrelli. 2004. Meeting patient and relatives' information needs upon transfer from an intensive care unit: the development and evaluation of an information booklet. *Journal of clinical nursing* 13, 3 (2004), 396–405.
- [54] Laura R. Pina, Sang-Wha Sien, Teresa Ward, Jason C. Yip, Sean A. Munson, James Fogarty, and Julie A. Kientz. 2017. From Personal Informatics to Family Informatics: Understanding Family Practices around Health Monitoring. In *Proceedings of the 2017 ACM Conference on Computer Supported Cooperative Work and Social Computing* (Portland, Oregon, USA) (CSCW '17). Association for Computing Machinery, New York, NY, USA, 2300–2315. <https://doi.org/10.1145/2998181.2998362>
- [55] Kathleen H. Pine, Claus Bossen, Yunan Chen, Gunnar Ellingsen, Miria Grisot, Melissa Mazmanian, and Naja Holten Møller. 2018. Data Work in Healthcare: Challenges for Patients, Clinicians and Administrators. In *Companion of the 2018 ACM Conference on Computer Supported Cooperative Work and Social Computing* (Jersey City, NJ, USA) (CSCW '18 Companion). Association for Computing Machinery, New York, NY, USA, 433–439. <https://doi.org/10.1145/3272973.3273017>
- [56] Bernd Ploderer, Justin Fong, Anusha Withana, Marlena Klacik, Siddharth Nair, Vincent Crocher, Frank Vetere, and Suranga Nanayakkara. 2016. ArmSleeve: a patient monitoring system to support occupational therapists in stroke rehabilitation. In *Proceedings of the 2016 ACM Conference on Designing Interactive Systems*. 700–711.
- [57] Peter Pronovost, Sean Berenholtz, Todd Dorman, Pam A Lipsett, Terri Simmonds, and Carol Haraden. 2003. Improving communication in the ICU using daily goals. *Journal of critical care* 18, 2 (2003), 71–75.
- [58] Leslie P Scheunemann, Michelle McDevitt, Shannon S Carson, and Laura C Hanson. 2011. Randomized, controlled trials of interventions to improve communication in intensive care: a systematic review. *Chest* 139, 3 (2011), 543–554.
- [59] Kumiko O Schnock, Sucheta S Ravindran, Anne Fladger, Kathleen Leone, Donna M Williams, Cynthia L Dwyer, Thanh-Giang Vu, Kevin Thornton, and Priscilla Gazarian. 2017. Identifying information resources for patients in the intensive care unit and their families. *Critical Care Nurse* 37, 6 (2017), e10–e16.
- [60] Jennifer J. Schnur, Angélica García-Martínez, Patrick Soga, Karla Badillo-Urquiola, Alejandra J. Botello, Ana Calderon Raisbeck, Sugana Chawla, Josef Ernst, William Gentry, Richard P. Johnson, Michael Kennel, Jesús Robles, Madison Wagner, Elizabeth Medina, Juan Garduño Espinosa, Horacio Márquez-González, Victor Olivar-López, Luis E. Juárez-Villegas, Martha Avilés-Robles, Elisa Dorantes-Acosta, Viridia Avila, Gina Chapa-Koloffon, Elizabeth Cruz, Leticia Luis, Clara Quezada, Emanuel Orozco, Edson Serván-Mori, Martha Cordero, Rubén Martín Payo, and Nitesh V. Chawla. 2024. SaludConectaMX: Lessons Learned from Deploying a Cooperative Mobile Health System for Pediatric Cancer Care in Mexico. In *Companion Publication of the 2024 Conference on Computer-Supported Cooperative Work and Social Computing* (San Jose, Costa Rica) (CSCW Companion '24). Association for Computing Machinery, New York, NY, USA, 316–322. <https://doi.org/10.1145/3678884.3685922>
- [61] Katayoun Sepehri, Liisa Holsti, Sara Niasati, Vita Chan, and Karon E Maclean. 2023. Beyond the Bulging Binder: Family-Centered Design of a Digital Health Information Management System for Caregivers of Children Living with Health Complexity. In *Proceedings of the 2023 CHI Conference on Human Factors in Computing Systems* (Hamburg, Germany) (CHI '23). Association for Computing Machinery, New York, NY, USA, Article 487, 19 pages. <https://doi.org/10.1145/3544548.3581459>
- [62] Farheen Siddiqui, Delvin Varghese, Pushpendra Singh, Sunita Bapuji Bayyavarapu, Stephen Lindsay, Dharshani Chandrasekara, Pranav Kulkarni, Ling Wu, Taghreed Alshehri, and Patrick Olivier. 2023. Exploring the digital support needs of caregivers of people with serious mental illness. In *Proceedings of the 2023 CHI Conference on Human Factors in Computing Systems* (Hamburg, Germany) (CHI '23). Association for Computing Machinery, New York, NY, USA, Article 560, 16 pages. <https://doi.org/10.1145/3544548.3580674>
- [63] Alistair Steel, Carol Underwood, Caitlin Notley, and Mark Blunt. 2008. The impact of offering a relatives' clinic on the satisfaction of the next-of-kin of critical care patients—A prospective time-interrupted trial. *Intensive and Critical Care Nursing* 24, 2 (2008), 122–129.
- [64] Harini Suresh, Nathan Hunt, Alistair Johnson, Leo Anthony Celi, Peter Szolovits, and Marzyeh Ghassemi. 2017. Clinical intervention prediction and understanding using deep networks. *arXiv preprint arXiv:1705.08498* (2017).
- [65] Alexis Tabah, Muhammed Elhadi, Emma Ballard, Andrea Cortegiani, Maurizio Cecconi, Takeshi Unoki, Laura Galarza, Regis Goulart Rosa, Francois Barbier, Elie Azoulay, et al. 2022. Variation in communication and family visiting policies in intensive care within and between countries during the Covid-19 pandemic: the COVISIT international survey. *Journal of critical care* 71 (2022), 154050.
- [66] David R Thomas. 2006. A general inductive approach for analyzing qualitative evaluation data. *American journal of evaluation* 27, 2 (2006), 237–246.
- [67] Harry Tunnell, Anthony Faiola, and Davide Bolchini. 2017. Guidelines to Incorporate a Clinician User Experience (UX) into the Design of Patient-Operated mHealth. In *Proceedings of the 2017 CHI Conference Extended Abstracts on Human Factors in Computing Systems* (Denver, Colorado, USA) (CHI EA '17). Association for Computing Machinery, New York, NY, USA, 385–388. <https://doi.org/10.1145/3027063.3052966>
- [68] Andreas Valentin, Patrick Ferdinande, and ESICM Working Group on Quality Improvement. 2011. Recommendations on basic requirements for intensive care units: structural and organizational aspects. *Intensive care medicine* 37 (2011), 1575–1587.

- [69] Robert M Wachter and Erik Brynjolfsson. 2024. Will generative artificial intelligence deliver on its promise in health care? *Jama* 331, 1 (2024), 65–69.
- [70] Jing Wei, Sungdong Kim, Hyunhoon Jung, and Young-Ho Kim. 2024. Leveraging large language models to power chatbots for collecting user self-reported data. *Proceedings of the ACM on Human-Computer Interaction* 8, CSCW1 (2024), 1–35.
- [71] Daksitha Senel Withanage Don, Dominik Schiller, Tobias Hallmen, Silvan Mertes, Tobias Baur, Florian Lingensfelder, Mitho Müller, Lea Kaubisch, Prof. Dr. Corinna Reck, and Elisabeth André. 2024. Towards Automated Annotation of Infant-Caregiver Engagement Phases with Multimodal Foundation Models. In *Proceedings of the 26th International Conference on Multimodal Interaction (San Jose, Costa Rica) (ICMI '24)*. Association for Computing Machinery, New York, NY, USA, 428–438. <https://doi.org/10.1145/3678957.3685704>
- [72] Jennifer L Wolff and Cynthia M Boyd. 2015. A look at person-centered and family-centered care among older adults: results from a national survey. *Journal of general internal medicine* 30 (2015), 1497–1504.
- [73] Jenna Wong, Mara Murray Horwitz, Li Zhou, and Sengwee Toh. 2018. Using machine learning to identify health outcomes from electronic health record data. *Current epidemiology reports* 5 (2018), 331–342.
- [74] Siyi Wu, Weidan Cao, Shihan Fu, Bingsheng Yao, Ziqi Yang, Changchang Yin, Varun Mishra, Daniel Addison, Ping Zhang, and Dakuo Wang. 2024. Clinical Challenges and AI Opportunities in Decision-Making for Cancer Treatment-Induced Cardiotoxicity. *arXiv preprint arXiv:2408.03586* (2024).
- [75] Ziqi Yang, Xuhai Xu, Bingsheng Yao, Ethan Rogers, Shao Zhang, Stephen Intille, Nawar Shara, Guodong Gordon Gao, and Dakuo Wang. 2024. Talk2Care: An LLM-based Voice Assistant for Communication between Healthcare Providers and Older Adults. *Proc. ACM Interact. Mob. Wearable Ubiquitous Technol.* 8, 2, Article 73 (May 2024), 35 pages. <https://doi.org/10.1145/3659625>
- [76] Dobin Yim, Jiban Khuntia, Vijaya Parameswaran, Arlen Meyers, et al. 2024. Preliminary Evidence of the Use of Generative AI in Health Care Clinical Services: Systematic Narrative Review. *JMIR Medical Informatics* 12, 1 (2024), e52073.
- [77] Changchang Yin, Shihan Fu, Bingsheng Yao, Thai-Hoang Pham, Weidan Cao, Dakuo Wang, Jeffrey Caterino, and Ping Zhang. 2024. SepsisCalc: Integrating Clinical Calculators into Early Sepsis Prediction via Dynamic Temporal Graph Construction. *arXiv preprint arXiv:2501.00190* (2024).
- [78] Hye Jin Yoo, Oak Bun Lim, and Jae Lan Shim. 2020. Critical care nurses' communication experiences with patients and families in an intensive care unit: A qualitative study. *Plos one* 15, 7 (2020), e0235694.
- [79] Amanda J Young, Elizabeth Stephens, and Joy V Goldsmith. 2017. Family caregiver communication in the ICU: Toward a relational view of health literacy. *Journal of Family Communication* 17, 2 (2017), 137–152.
- [80] Shao Zhang, Jianing Yu, Xuhai Xu, Changchang Yin, Yuxuan Lu, Bingsheng Yao, Melanie Tory, Lace M. Padilla, Jeffrey Caterino, Ping Zhang, and Dakuo Wang. 2024. Rethinking Human-AI Collaboration in Complex Medical Decision Making: A Case Study in Sepsis Diagnosis. In *Proceedings of the 2024 CHI Conference on Human Factors in Computing Systems (Honolulu, HI, USA) (CHI '24)*. Association for Computing Machinery, New York, NY, USA, Article 445, 18 pages. <https://doi.org/10.1145/3613904.3642343>

A Formative Study - Interview Script

- **Question 1 - Experience:** Can you describe your experience as a caregiver when your loved one was transferred to the ICU?
- **Question 2 - Information:** What kind of information did you seek as a caregiver and what was your experience accessing and understanding the information?
- **Question 3 - Technology Use:** How did you utilize digital tools, such as the patient portal or search engines, to gather information?
- **Question 4 - Technology Expectation:** What do you expect of an AI-powered digital tool that is designed to help you in such a situation? Would you trust the AI?

B Evaluation Study Interview Script

The following set of questions was asked for each interface presented to the participants.

- **Question 1 - Feedback on the Design:** (After showing a screenshot of the UI) How do you like this interface?
- **Question 2 - Utility:** Do you think this function would be useful to you? Why or why not?
- **Question 3 - Use Cases:** How would you use this interface/function? [What kind of questions would you ask this chatbot?]
- **Question 4 - Improvement:** What improvements can be made?

Received 20 February 2007; revised 12 March 2009; accepted 5 June 2009