

# STATUS OF THE DESIGN OF THE LBNE NEUTRINO BEAMLINE\*

V. Papadimitriou<sup>#</sup>, R. Andrews, M. Campbell, A. Chen, S. Childress, C. D. Moore,

Fermilab, Batavia, IL 60510, USA

## Abstract

The Long Baseline Neutrino Experiment (LBNE) will utilize a neutrino beamline facility located at Fermilab to carry out a compelling research program in neutrino physics. The facility will aim a beam of neutrinos toward a detector placed at the Homestake Mine in South Dakota, about 1300 km away. The neutrinos are produced as follows: First, protons extracted from the MI-10 section of the Main Injector (60-120 GeV) hit a solid target above grade and produce mesons. Then, the charged mesons are focused by a set of focusing horns into a 200 m long decay pipe, towards the far detector. Finally, the mesons that enter the decay pipe decay into neutrinos. The parameters of the facility were determined taking into account several factors including the physics goals, the modelling of the facility, spacial and radiological constraints and the experience gained by operating the NuMI facility at Fermilab. The initial beam power is expected to be ~700 kW, however some of the parameters were chosen to be able to deal with a beam power of 2.3 MW in order to enable the facility to run with an upgraded accelerator complex. We discuss here the status of the design and the associated challenges.

## INTRODUCTION

The Neutrino Beamline is the central component of LBNE, and its driving physics considerations are the long baseline neutrino oscillation analyses. These include the search for, and precision measurement of, the parameters that govern  $\nu_\mu$  to  $\nu_e$  oscillations as well as precision measurements of  $\theta_{23}$  and  $|\Delta m^2_{32}|$  in the  $\nu_\mu$  disappearance channel. On January 8, 2010, the Department of Energy approved the “Mission Need” for LBNE and the LBNE Project is developing a conceptual design to meet this Mission Need.

The Neutrino Beamline facility is expected to be fully contained within Fermilab property. The primary proton beam, in the energy range of 60-120 GeV, will be extracted from the Main Injector [1] using “single-turn” extraction. For 120 GeV operation and with the Main Injector upgrades implemented for the NOvA experiment [2], the fast, single turn extraction will deliver all the protons ( $4.9 \times 10^{13}$ ) in one machine cycle (1.33 sec) to the LBNE target in 10  $\mu$ s. The beam power is expected to be ~700 kW in the energy range of 80 to 120 GeV. The charged mesons produced by the interaction of the protons with the target are focused by two magnetic horns into the decay pipe towards the far detector. These

mesons are short-lived and decay into muons and neutrinos. At the end of the decay region, an absorber pile is needed to remove the residual particles remaining at the end of the decay pipe. The neutrino beam is aimed at the Homestake Mine in South Dakota, about 1300 km away, with a 5.8° vertical bend.

A wide band neutrino beam is needed to cover the first and second neutrino oscillation maxima, which for a 1300 km baseline are expected to be approximately at 2.3 and 0.8 GeV. The beam must provide a concentrated neutrino flux at the energies bounded by the oscillation peaks and we are therefore optimizing the beamline design for neutrino energies in the area 0.5 to 5 GeV. The initial operation of the facility will be at a beam power incident on the production target of ~700 kW, however some of the initial implementation will have to be done in such a manner that operation at 2.3 MW can be achieved without retrofitting. Such a higher beam power is expected to become available in the future with the planned Project X [3] which includes the replacement of the existing proton source that feeds the Main Injector. In general, components of the LBNE beamline system which cannot be replaced or easily modified after substantial irradiation at 700 kW operation are being designed for 2.3 MW. Examples of such components are the shielding of the target chase and the decay pipe, and the absorber.

The LBNE Beamline design has to implement as well stringent limits on the radiological protection of the environment, workers and members of the public. The relevant radiological concerns, prompt dose, residual dose, air activation and tritium production have been extensively modeled and the results implemented in the system design. A software model for the entire beamline has been coded into the MARS15 simulation package [4]. A most important aspect of modeling at the present design stage is the determination of the necessary shielding thickness and composition in order to protect the ground water and the public and to control air emissions.

This paper is a snapshot of the present status of the design as exemplified in the current Conceptual Design Report [5].

## THE BEAMLINE REFERENCE DESIGN

The Beamline team developed and evaluated many value engineering proposals. In this context it defined and costed four beamline configurations with varying primary beam extraction points and beamline depth. For two of the configurations we considered a longer beamline extracting from the MI-60 straight section of the Main Injector (same as for NuMI) and for two of them considered a shorter beamline extracting from the MI-10

\*Work supported by DOE, contract No. DE-AC02-07CH11359  
#vaia@fnal.gov

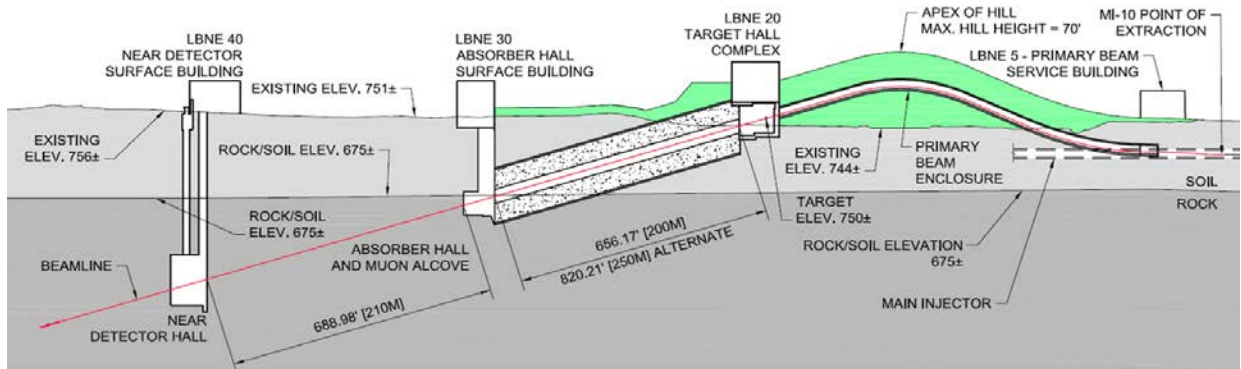

Figure 1: Longitudinal section of the LBNE Beamline facility in the MI-10, Shallow beamline configuration.

section. For each extraction point we considered a deep option with excavation in soil and in rock and a shallow option featuring a large berm into which facilities would be constructed.

In June, 2011 we selected two of the four beamline configurations to develop further towards the conceptual design review, and we applied on them as many, smaller scope, value engineering proposals as possible. These two designs are being referred to as MI-60, Deep and MI-10, Shallow. They both feature a 200 m long decay pipe with a diameter of 4 m and a muon range-out distance between the absorber and the Near Detector of 210 m. In November, 2011 we selected the MI-10, Shallow design as the LBNE reference design.

### *The MI-10, Shallow conceptual design*

Figure 1 shows a longitudinal section of the LBNE Beamline facility in the MI-10, Shallow beamline configuration. At MI-10 there is no existing extraction enclosure and we are minimizing the impact on the Main Injector by introducing a 15.6 m long beam carrier pipe to transport the beam through the Main Injector tunnel wall into the new LBNE enclosure. A group of technical components sends the proton beam through an above-grade beamline covered by a man-made embankment/hill whose apex is ~22 m and its footprint ~318,000 sq. ft. The beam then will be bent downward toward a target located at grade level. The overall bend of the proton beam is  $7.2^\circ$  westward and  $5.8^\circ$  downward to establish the final trajectory toward the far detector. In this design the primary beam enclosure and the Target Hall complex are supported on rock using drilled piers.

In this shallow option, because of the presence of a local aquifer at and near the top of the rock surface we cannot permit groundwater to migrate toward and into the decay region (there will be a significant amount of daily collection) and therefore we have to provide an engineered geomembrane barrier between the shielding and the environment. The decay pipe shielding thickness has been determined to be 5.5 m

of concrete (see Fig. 2). In this configuration, since the Target Hall and Decay Pipe are not deep into rock, we also had to check and verified that the total radiation dose at the Fermilab boundary is about four orders of magnitude below the LBNE related allowed dose of 1mrem/year.

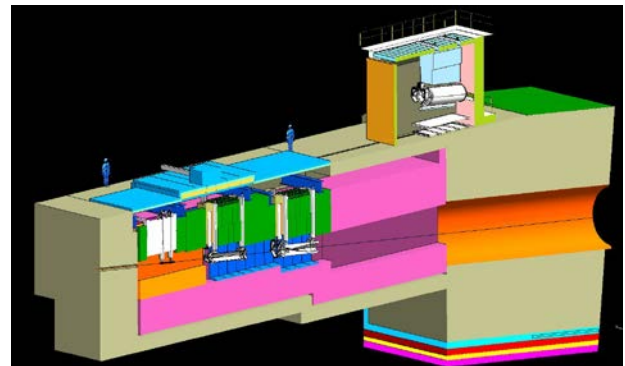

Figure 2: Section of the Target Hall complex and the Decay Pipe.

### *Status of the conceptual design*

The LBNE Beamline scope includes a Primary Beam, a Neutrino Beam and System Integration. System Integration works throughout Primary and Neutrino Beam and it includes Alignment, Controls, Interlocks, and Installation Coordination. The Primary Beam elements necessary for transport include vacuum pipes, dipole, quadrupole and corrector magnets and beam monitoring equipment (Beam Position Monitors, Beam Loss Monitors, Beam Profile Monitors, etc.). The magnets are conventional, Main Injector design, and the magnet power supplies are a mixture of new, Main Injector design power supplies or refurbished Tevatron power supplies. The beam optics accommodates a range of spot sizes on the target in the energy range of interest and for beam power up to 2.3 MW, and the beam transport is expected to take place with minimal losses. All of the

conceptual design effort for the Primary Beam is taking place at Fermilab.

The Neutrino Beam includes in order of placement (1) a baffle collimator assembly to protect the target and the horns, (2) a target, (3) two magnetic horns. These elements are all located inside a heavily shielded vault, called the target chase, that is open to the decay pipe at the downstream end. An air-filled, air-cooled decay pipe follows which allows pions and kaons to decay to neutrinos, and in the end of it is the absorber which is a specially designed pile of aluminum, steel and concrete blocks, some of them water cooled, which must contain the energy of the particles that exit the decay pipe. Radiation damage and cooling of elements, tritium mitigation, remote handling and storage of radioactive components are essential considerations for the conceptual design of the Neutrino Beam. Most of the design effort for the Neutrino Beam is taking place at Fermilab except from the designs of the primary beam window, the target, the horn support modules and the remote handling for which we have established collaborations with other institutions.

The reference design of the target assembly is based on work done at the Institute of High Energy Physics (IHEP) in Protvino, Russia [6]. The target is a 95 cm long cylinder consisting of 48 small cylinders with diameter of 15.3 mm and spaced 0.2 mm apart. The target material is POCO ZXF-50 graphite and it is water cooled. In order to capture low energy pions and kaons from the target at large production angles, the target assembly is inserted well into the first horn's magnetic lens whose inner conductor is cylindrical/parabolic in shape. We are in the process of comparing the properties and longevity of the POCO graphite with other target sample materials which we have irradiated at the BLIP facility of the Brookhaven National Laboratory. Another approach is to consider beryllium as an alternative target which is expected to be more resistant to radiation than graphite. Colleagues from Rutherford Appleton Laboratory (RAL) have analyzed the issues associated with a potential beryllium target and have concluded that a 13 mm diameter, 1 m long cylinder (or a segmented target) falls inside the chosen design point stress for 700 kW operation [7].

The conceptual design effort for the LBNE Beamline (including System Integration) is complete at this point for the reference design. In view of financial considerations the LBNE Project was asked in April, 2012 to consider and evaluate staging options, and the Beamline team is in the process of implementing additional value engineering and considering various staging scenarios. A final report describing these options is due to the Fermilab Director in the end of June, 2012.

## CONCLUSION

The LBNE Beamline has been at a technical status suitable for a conceptual design review for a NuMI-style beamline, mostly in rock, since September, 2010. Since then we developed and reviewed several value engineering proposals with the goal of reducing the cost further. We have considered and costed four beamline configurations at different depths and primary beam extraction points from Fermilab's Main Injector, and in the end of June, 2011 we selected two of them as designs to be developed further. We developed conceptual design reports and a set of risks for both of these designs.

After a thorough review of both conceptual designs, on November 10, 2011 we selected as the reference beamline configuration the MI-10, Shallow option. We developed this beamline concept fully, and we went through a successful conceptual design Fermilab Director's review in March, 2012. We are now in the process of reconfiguring the LBNE Project to follow a staged approach and anticipate a DOE conceptual design review by the end of 2012.

## ACKNOWLEDGMENT

We would like to thank all the members of the LBNE Beamline team for their numerous contributions towards developing and costing the Beamline conceptual design.

## REFERENCES

- [1] Fermilab Main Injector Technical Design Handbook, November 1995, [http://www-fmi.fnal.gov/fmiinternal/MI\\_Technical\\_Design/index.html](http://www-fmi.fnal.gov/fmiinternal/MI_Technical_Design/index.html)
- [2] D.S. Ayres et al., NOvA Technical Design Report, October 2007, [http://www-nova.fnal.gov/nova\\_cd2\\_review/tdr\\_oct\\_23/toc.pdf](http://www-nova.fnal.gov/nova_cd2_review/tdr_oct_23/toc.pdf)
- [3] Project X documents, <http://projectx.fnal.gov/>
- [4] N.V. Mokhov, S.I. Striganov, "MARS15 Overview", in Proc. of Hadronic Shower Simulation Workshop, Fermilab, September 2006, AIP Conf. Proc. 896, pp. 50-60 (2007); <http://www-ap.fnal.gov/MARS/>
- [5] LBNE Conceptual Design Report, Volume 2, "The LBNE Beamline", pp. 1-197 (2012); <http://lbne2-docdb.fnal.gov:8080/cgi-bin/ShowDocument?docid=4317>
- [6] V. Garkusha et al., IHEP Report on Graphite Target, <http://lbne2-docdb.fnal.gov:8080/cgi-bin/ShowDocument?docid=2423>
- [7] C. J. Densham et al., Conceptual Design Study of the LBNE Target and Beam Window, [http://lbne2-docdb.fnal.gov:8080/0024/002400/002/LBNE\\_RAL\\_Final\\_Report\\_v1.0.pdf](http://lbne2-docdb.fnal.gov:8080/0024/002400/002/LBNE_RAL_Final_Report_v1.0.pdf)